

LEGEND:

- P 1** VISITORS CAR PARK
- P 2** STUDENT CAR PARK
- P 3** STAFF CAR PARK
- 4** PREFABS
- 5** SPORTS HUB
- 6** ALL WEATHER PITCH
- 7** PLAYING PITCHES
- 8** MAIN BUILDING
- 9** RESTAURANT BLOCK
- 10** AULA MAXIMA
- 11** MILLENNIUM THEATRE
- + 12** BLOCK 12 HEALTH UNIT
- 13** BLOCK 13
- 14** BLOCK 14 STUDENTS UNION
- 15** BLOCK 15 INTERNATIONAL OFFICE
- 16** HEAC BUILDING
- 17** BIKE SHED
- 18** SPORTS CHANGING VILLAGE
- Bus** BUS TO CITY CENTRE
- ♿** ACCESSIBLE PARKING

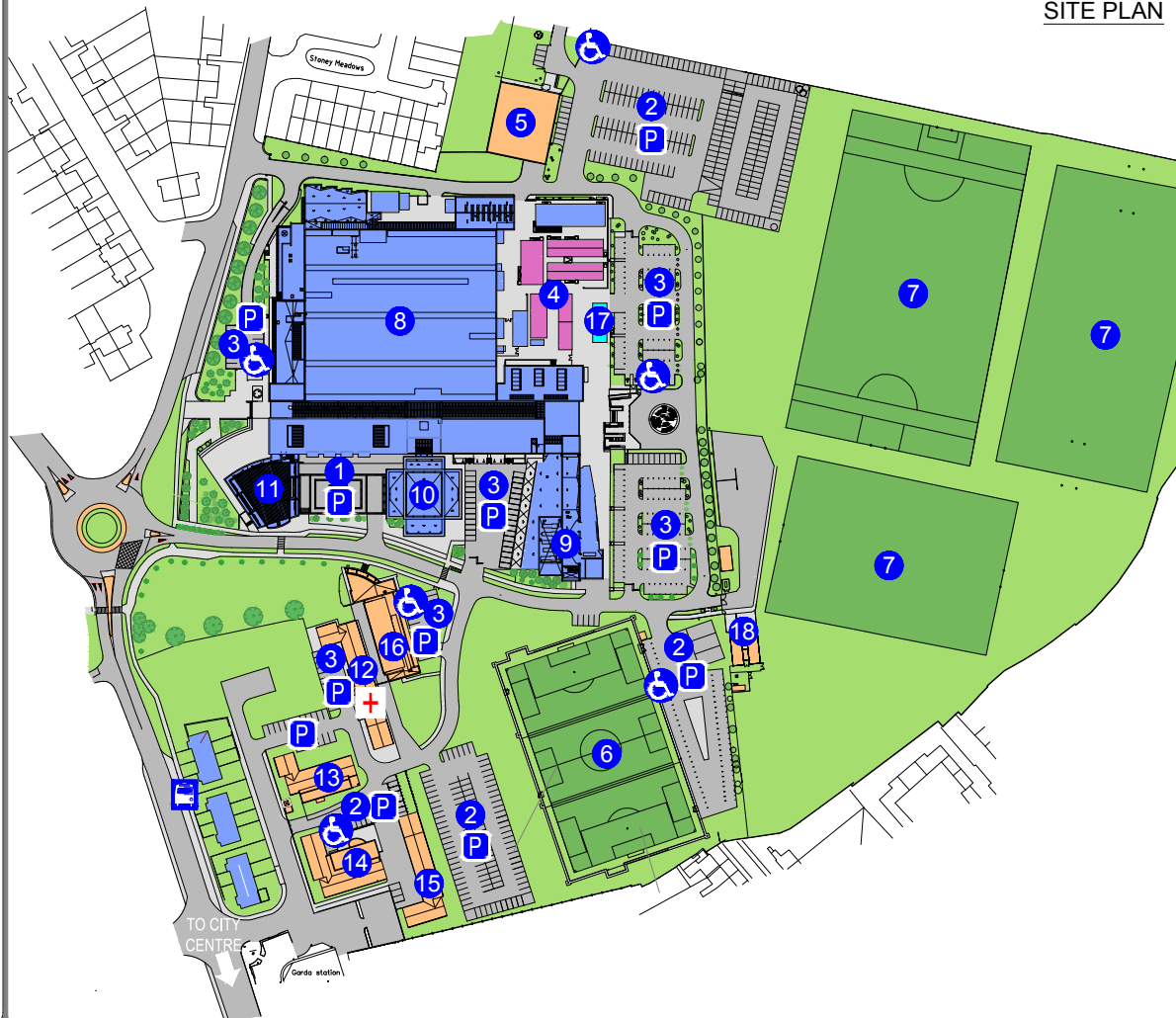

MOYLISH MAIN BUILDING
GROUND FLOOR







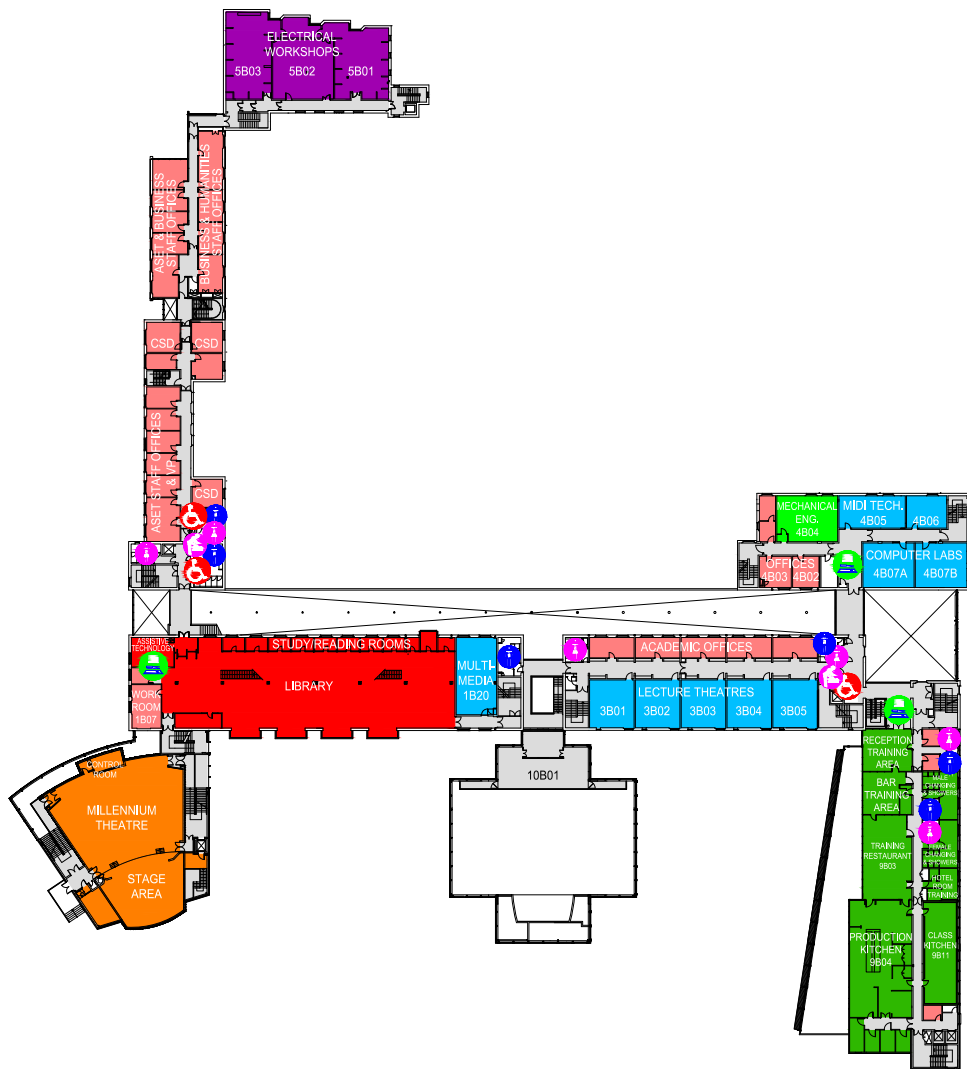





LEGEND:

- | | | |
|---|-----------------------------|-----------------------------------|
| STUDENT SERVICES | ELECTRICAL, ELECTRONIC & IT | ACCESSIBLE WC |
| AMENITIES (SPORT, LEISURE & RESTAURANT) | MECHANICAL & AUTOMOBILE | BABY CHANGING |
| LECTURE ROOMS & PREFABS | STAFF OFFICES | ATM |
| TRADES | MALE WC | OPEN ACCESS COMPUTER WORKSTATIONS |
| SCIENCE | FEMALE WC | |

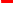

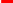
LEGEND:

- | | | |
|--|---|---|
|  STUDENT SERVICES |  ELECTRICAL & ELECTRONIC |  FEMALE WC |
|  MILLENNIUM THEATRE |  STAFF OFFICES |  ACCESSIBLE WC |
|  LECTURE ROOMS |  MECHANICAL |  BABY CHANGING |
|  HOSPITALITY |  MALE WC |  OPEN ACCESS COMPUTER WORKSTATIONS |

MOYLISH MAIN BUILDING
SECOND FLOOR

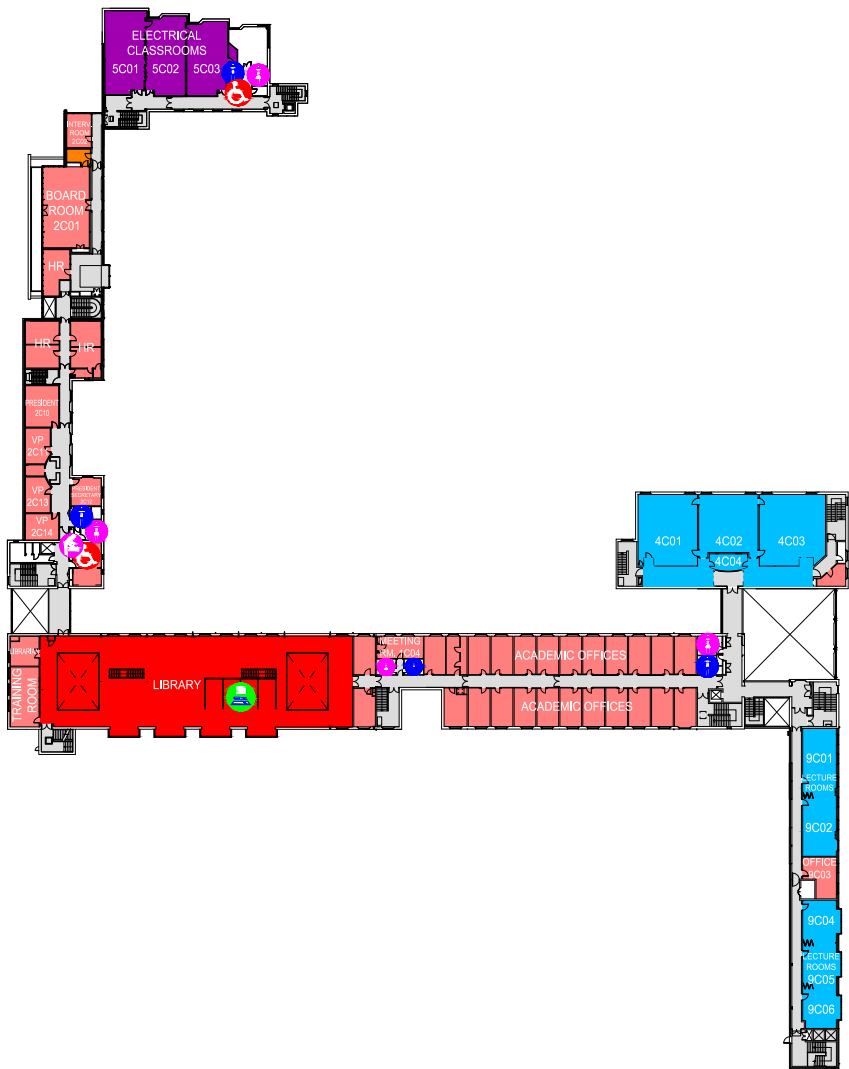

LEGEND:

- | | |
|-------------------------|-----------------------------------|
| STUDENT SERVICES | FEMALE WC |
| LECTURE ROOMS | ACCESSIBLE WC |
| ELECTRICAL & ELECTRONIC | BABY CHANGING |
| STAFF OFFICES | OPEN ACCESS COMPUTER WORKSTATIONS |
| MALE WC | |